

SM60K



INSULATION FIXING WITH NAIL - ETA APPROVED

Insulation plug with 60mm disc and short expansion segment.



ADVANTAGES

- The plastic nail reduces the heat transmission. The version with steel nail has a cover cap to reduce the heat transmission and to prevent marks on the plaster surface.
- Simple hammer-in for quick installation. The special disc profile allows optimum adhesion of plaster.
- Low anchorage depth reduces the drilling depth.

FUNCTIONING

- Push-through installation.
- The plug will expand in when the nail is hammered-in.
- Non-bearing layers, such as adhesive and/or old render and plaster, must be included in the anchor's useful length.

ISOLATIEPLUG MET STALEN NAGEL - ETA GEKEURD

Pleisterplug uit slagvast kunststof met schijf 60mm.

VOORDELEN

- De kunststof bevestiging voorkomt koudebruggen.
- Snelle en eenvoudige montage.
- Kleine verankeringsdiepte.

TOEPASSING

- Doorsteekinstallatie.
- De plug klemt zich tegen de boorwand wanneer de nagel wordt doorgeslagen.
- Niet-dragende lagen, zoals oud pleisterwerk, moeten worden meegeteld in de nuttige lengte.

FIXATION POUR ISOLANTS - APROBATION ATE

Fixation pour isolants enduits avec disque 60mm.

AVANTAGES

- Cheville en nylon réduit les ponts thermiques.
- Montage rapide, facile et économique.
- Profondeur d'installation faible.

APPLICATION

- Installation traversante.
- Lorsque le clou est enfoncé, la cheville se fixe dans le trou.
- Les couches non-porteuses, comme les enduits anciens, doivent être inclus dans la longueur utile.

INSTALLATION SCHEME

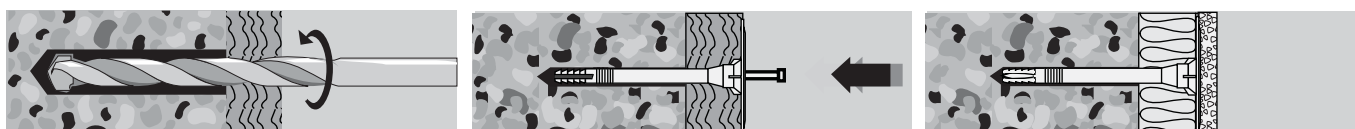

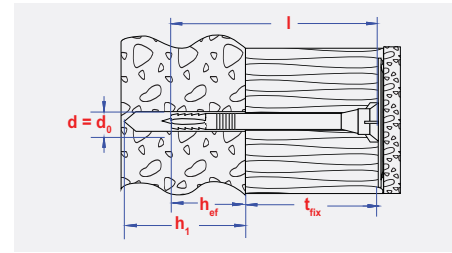

INFO

d	l	d ₀	h ₁	h _{ef}	t _{fix}
[mm]	[mm]	[mm]	[mm]	[mm]	[mm]
10	70	10	60	50	20
10	90	10	60	50	40
10	100	10	60	50	50
10	120	10	60	50	70
10	140	10	60	50	90
10	160	10	60	50	110
10	180	10	60	50	130
10	200	10	60	50	150
10	220	10	60	50	170
10	260	10	60	50	210



Carton box packing - Kartonverpakking - Boîte carton

size	pgb code	EAN13	
10x70	SM60K310070 NZN	5902134723594	250
10x90	SM60K310090 NZN	5902134723600	200
10x100	SM60K310100 NZN	5902134723617	200
10x120	SM60K310120 NZN	5902134723624	150
10x140	SM60K310140 NZN	5902134723631	150

size	pgb code	EAN13	
10x160	SM60K310160 NZN	5902134723648	120
10x180	SM60K310180 NZN	5902134723655	120
10x200	SM60K310200 NZN	5902134723662	100
10x220	SM60K310220 NZN	5902134723679	100
10x260	SM60K310260 NZN	5902134725482	80

LOADS - BELASTINGEN - CHARGES

Approved loads for a single anchor. ¹⁾

Maximaal toegestane belasting voor één anker.

Charges maximales approuvées pour un ancrage simple.

Type 60K		ø 10	
Min. spacing / Min h.o.h.-afstand / Distance entre-axes min.	s _{min}	[mm]	100
Min. thickness of concrete member / Min. betondikte / Epaisseur min. du béton	h _{min}	[mm]	100
Min. edge distance / Min. randafstand / Distance au bord min.	C _{min}	[mm]	100
Concrete / Beton / Béton	C12/15	[kN]	0,25
Concrete / Beton / Béton	C16/20 + C50/60	[kN]	0,38
Solid clay brick / Volle baksteen / Brique pleine	EN 771-1 ≥ 1,46	[kN]	0,45

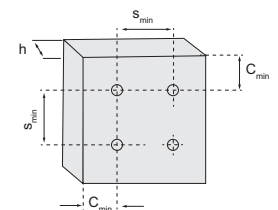

Insulation fixings

¹⁾ According to / volgens / suivant ETA-10/0214

Including partial safety factors $\gamma_M = 2,0$ / Inclusief veiligheidsfactor $\gamma_M = 2,0$ / Inclusif coefficient partiel de sécurité $\gamma_M = 2,0$.